

Job Name \_\_\_\_\_

Contractor \_\_\_\_\_

Job Location \_\_\_\_\_

Approval \_\_\_\_\_

Engineer \_\_\_\_\_

Contractor's P.O. No. \_\_\_\_\_

Approval \_\_\_\_\_

Representative \_\_\_\_\_

# Series 7001, 7002

## UL/FM Fire Service Strainer

### Sizes: 3" – 10" (80 – 250mm)

Series 7001, 7002 UL/FM Fire Service Strainer is used in non-potable applications in conjunction with a water spray system to protect the system against clogging that can be caused by particles fouling the small discharge opening of the sprinkler heads. Strainers for fire systems are designed to trap foreign material 1/4" diameter or larger. This type of strainer is usually installed upstream of most of the devices in the system including the meters, backflow preventers (or detector check valves) and flow alarms, in order to protect these devices from damage caused by large particles.

### Features

- Epoxy coated fabricated steel strainer, flange x flange, groove x groove or groove x flange with single or dual cleanouts
- Large solids trap to minimize screen blockage
- 304 stainless steel strainer element

### Specifications

The strainer shall be designed to permit removal of the filter for replacement and repair without removing the body from the line. A flush outlet shall be provided with each strainer. The filter shall withstand 125 psi (8,6 bar) when plugged. Friction loss shall not exceed 10 psi (69 kPa) when tested with foreign materials (gravel) equal to 2 1/2' (762mm) of filled pipe trapped in the strainer. Open screen area shall be at least 6 times greater than the nominal pipe size open area. Friction loss shall not exceed 3 psi (21 kPa) at rated flow when tested with clean filter and clean water. The strainer shall be an Ames Fire & Waterworks Series 7001, 7002.

### Pressure – Temperature

Maximum Working Pressure: 175 psi (12.1 bar).

Water temperature up to 140°F (60°C)

### Materials

Body & Cover: Fusion-bonded epoxy coated steel.

Screen: 304 stainless steel, .25 diameter perforation

Clean-Out Plug: Brass or Bronze

Flanges: AWWA Class "D"

Grooves: AWWA C606

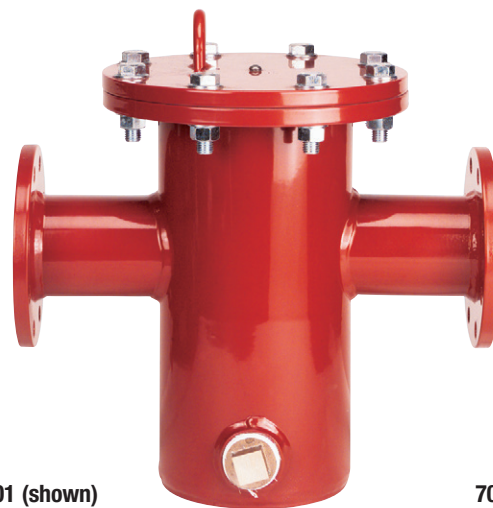

**7001 (shown)**  
One Cleanout

**7002**  
Two Cleanouts

### Approvals



#### WARNING

It is illegal to use this product in any plumbing system providing water for human consumption, such as drinking or dishwashing, in the United States. Before installing standard material product, consult your local water authority, building and plumbing codes.

#### NOTICE

The information contained herein is not intended to replace the full product installation and safety information available or the experience of a trained product installer. You are required to thoroughly read all installation instructions and product safety information before beginning the installation of this product.

Ames Fire & Waterworks product specifications in U.S. customary units and metric are approximate and are provided for reference only. For precise measurements, please contact Ames Fire & Waterworks Technical Service. Ames Fire & Waterworks reserves the right to change or modify product design, construction, specifications, or materials without prior notice and without incurring any obligation to make such changes and modifications on Ames Fire & Waterworks products previously or subsequently sold.



# Series 7001, 7002

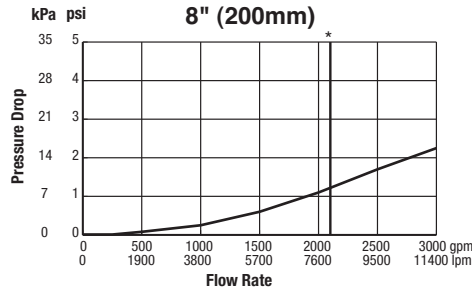
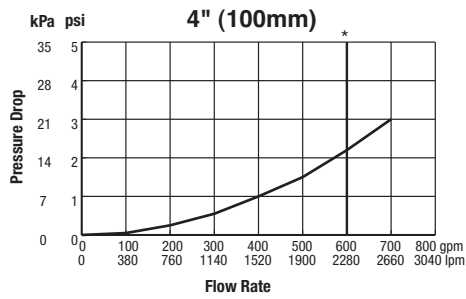
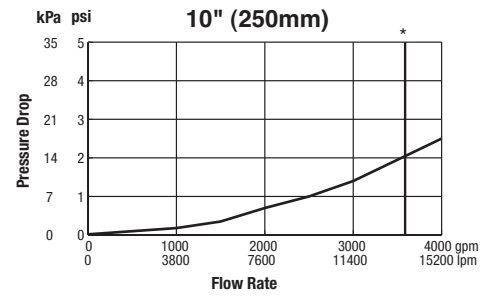
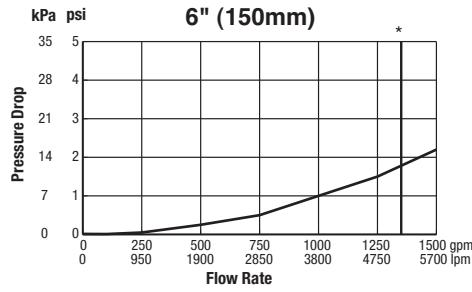
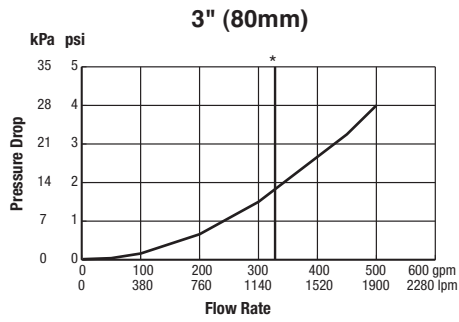

## Dimensions – Weights

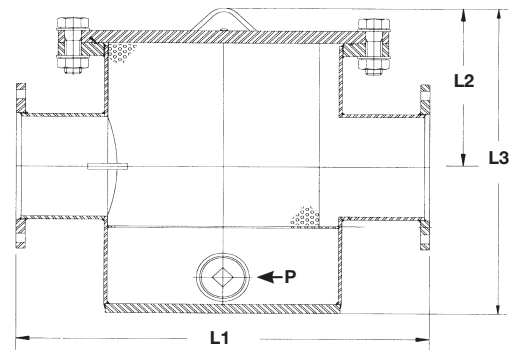
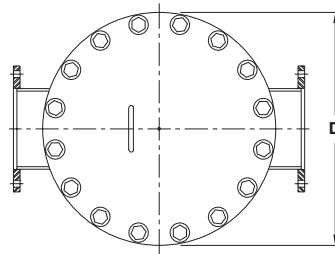

SIZE (DN)		DIMENSIONS															
in.	mm	Nom Rated Flow		D		L1		L2		L3		P		STD Perf Dia		Shipping Weight	
		GPM	LPM	in.	mm	in.	mm	in.	mm	in.	mm	in.	mm	in.	mm	lbs.	kg
3	80	325	1235	13½	343	14⅞	359	10	254	20%	524	2	51	¼	6.4	70	32
4	100	600	2280	13½	343	21	533	10%	270	20%	524	2	51	¼	6.4	120	54
6	150	1350	5130	19	483	26⅞	683	11¼	286	22%	568	3	76	¼	6.4	232	105
8	200	2100	7980	25	635	31¼	794	13	330	25%	637	3	76	¼	6.4	560	254
10	250	3600	13680	27½	699	30	762	14½	368	29⅞	744	3 (x2)	76	¼	6.4	570	256



**A WATTS Brand**

USA: Backflow Tel: (978) 689-6066 • Fax: (978) 975-8350 • AmesFireWater.com  
 USA: Control Valves Tel: (713) 943-0688 • Fax: (713) 944-9445 • AmesFireWater.com  
 Canada: Tel: (905) 332-4090 • Fax: (905) 332-7068 • AmesFireWater.ca  
 Latin America: Tel: (52) 81-1001-8600 • AmesFireWater.com